

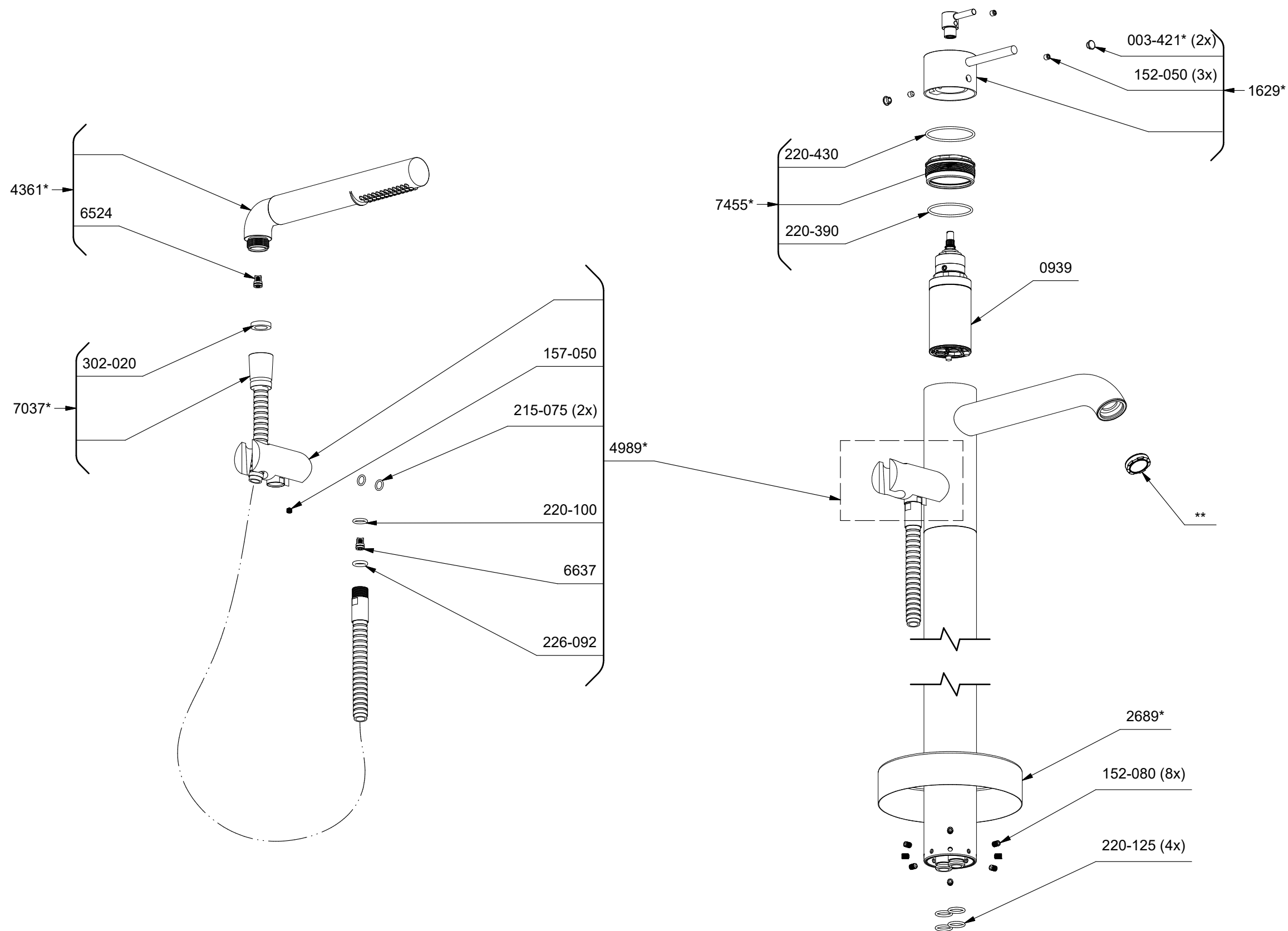

**TCO39**

Conik  
2-way Type T coaxial floor-mount tub filler with hand shower

\*Les dimensions, les modèles et les finis présentés peuvent différer. / Sizes, models and finishes may differ from those presented.



**\*Finish determined by Suffix**

Finish	Description
C	Chrome
BK	Black

**\*\*Aerator Kit (Include tool) :**

S6-676 (Full flow)

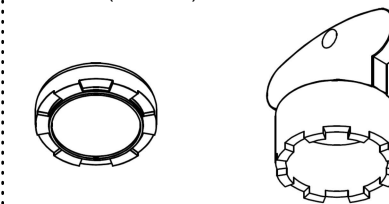

**TOOL :**

505-025 (Allen key 2.5mm)

